

4th Asian Symposium on Materials Processing (ASMP 2015)



QIR

Lombok
Indonesia

10-13
August
2015

Organizing Committee

Symposium Chair

Prof. Hideshi Miura (Kyushu University, JAPAN)

General Chair

Prof. Masaaki Otsu (University of Fukui, JAPAN)

Dr. Gandjar Kiswanto (University of Indonesia, INDONESIA)

Co-General Chair

Prof. Ming Yang (Tokyo Metropolitan University, JAPAN)

Dr. Ario Sunar Baskoro (University of Indonesia, INDONESIA)

International Advisory Committee

Prof. Naoto Ohtake (Tokyo Institute of Technology, JAPAN)

Prof. Hiroshi Asanuma (Chiba University, JAPAN)

Dr. Gandjar Kiswanto (University of Indonesia, INDONESIA)

Prof. Ahmad Fauzi Mohd Noor (USM, MALAYSIA)

Dr. Zainuddin Sajuri (UKM, MALAYSIA)

Prof. Chaosuan Kanchanomai (Thammasat University, THAILAND)

Dr. Zainuddin Sajuri (Universiti Kebangsaan Malaysia, MALAYSIA)

Prof. Syoni Soepriyanto (Institute of Technology Bandung, INDONESIA)

Scientific & Program Committee

Prof. Yukio Miyashita (Nagaoka University of Technology, JAPAN)(Chair)

Dr. Sugeng Supriadi (University of Indonesia, INDONESIA)(Chair)

Dr. Yudan Whulanza (University of Indonesia, INDONESIA)

Dr. Jos Istiyanto (University of Indonesia, INDONESIA)

Prof. Nobuo Takeda (University of Tokyo, JAPAN)

Prof. Kenji Kaneko (Tokyo University of Science, JAPAN)

Prof. Masaaki Itabashi (Tokyo University of Science, Suwa, JAPAN)

Prof. Hideki Kyogoku (Kinki University, JAPAN)

Prof. Ikuo Ihara (Nagaoka University of Technology, JAPAN)

Prof. Masanobu Kubota (Kyusyu University, JAPAN)

Prof. Hiroyuki Kawada (Waseda Univeristy, JAPAN)

Prof. Toshio Hattori (Shizuoka Institute of Science and Technology, JAPAN)

Prof. Hiroshi Asanuma (Chiba University, JAPAN)

Prof. Koji Fujimoto (The University of Tokyo, JAPAN)

Dr. Tsutomu Murai (Japan Science and Technology Agency, JAPAN)

Prof. Masahiro Fukumoto (Toyohashi University of Technology, JAPAN)

Prof. Hironori Tohmyo (Tohoku Univeristy, JAPAN)

Prof. Shinji Ogiwara (Tokyo University of Science, JAPAN)

Prof. Satoshi Kobayashi (Tokyo Metropolitan University, JAPAN)

Prof. Shuichi Wakayama (Tokyo Metropolitan University, JAPAN)

Prof. Hiroki Akasaka (Tokyo Institute of Technology, JAPAN)

Prof. Ryo Matsumoto (Osaka University, JAPAN)

Prof. Hidemitsu Furukawa (Yamagata University, JAPAN)

Prof. Mikio Muraoka (Akita University, JAPAN)

Prof. Ming Yang (Tokyo Metropolitan University, JAPAN)

Dr. Miki Yamazaki (Hitachi, JAPAN)

Prof. Wataru Nakao (Yokohama National University, JAPAN)

Symposium Secretary

Prof. Masato Okada (University of Fukui, JAPAN)

Ms. Herra Asta (University of Indonesia, INDONESIA)

ACTIVITY LOCATOR AND FLOOR PLANS

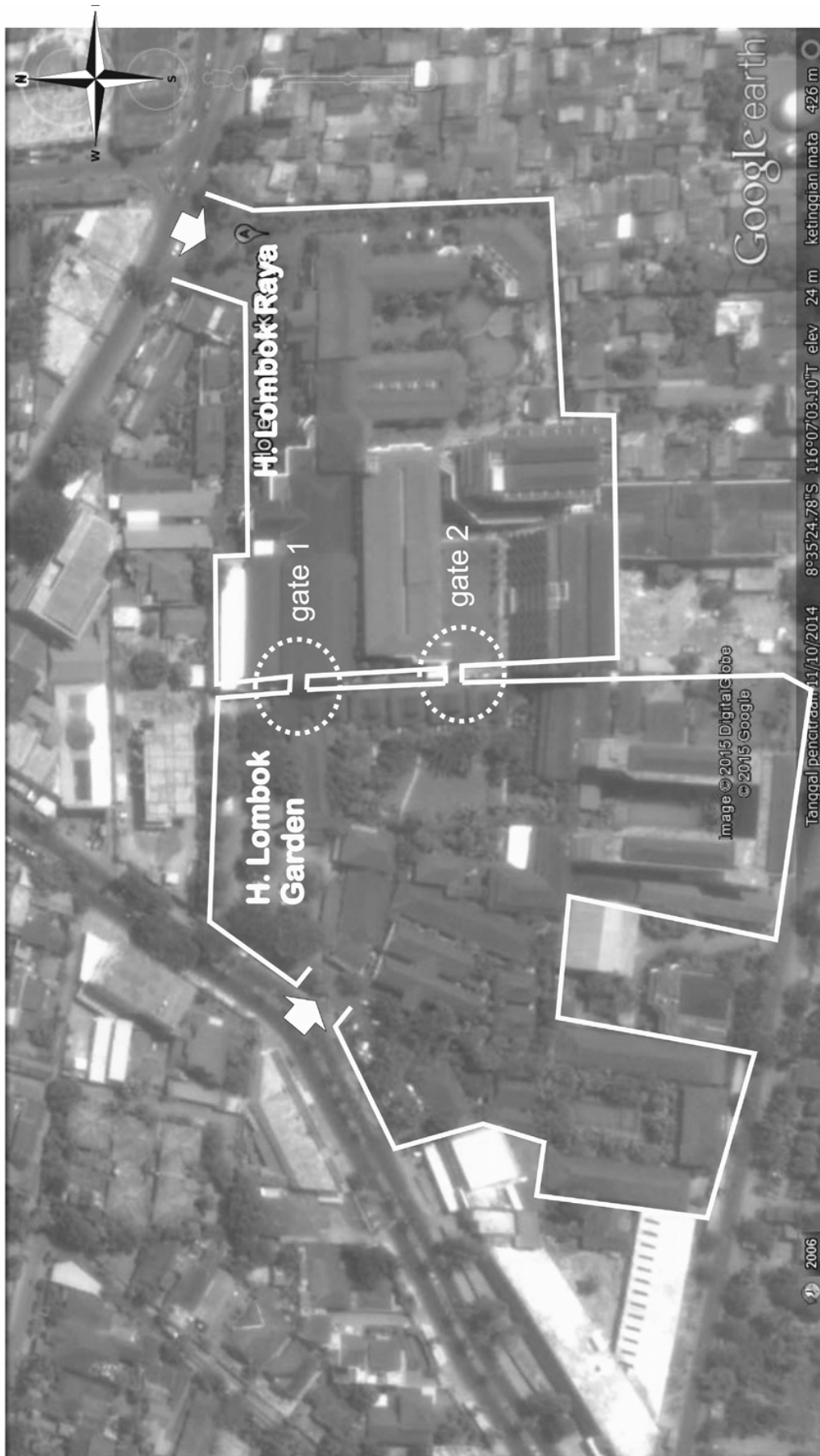

LAYOUT H. LOMBOK RAYA DAN H. LOMBOK GARDEN

ACTIVITY LOCATOR AND FLOOR PLANS

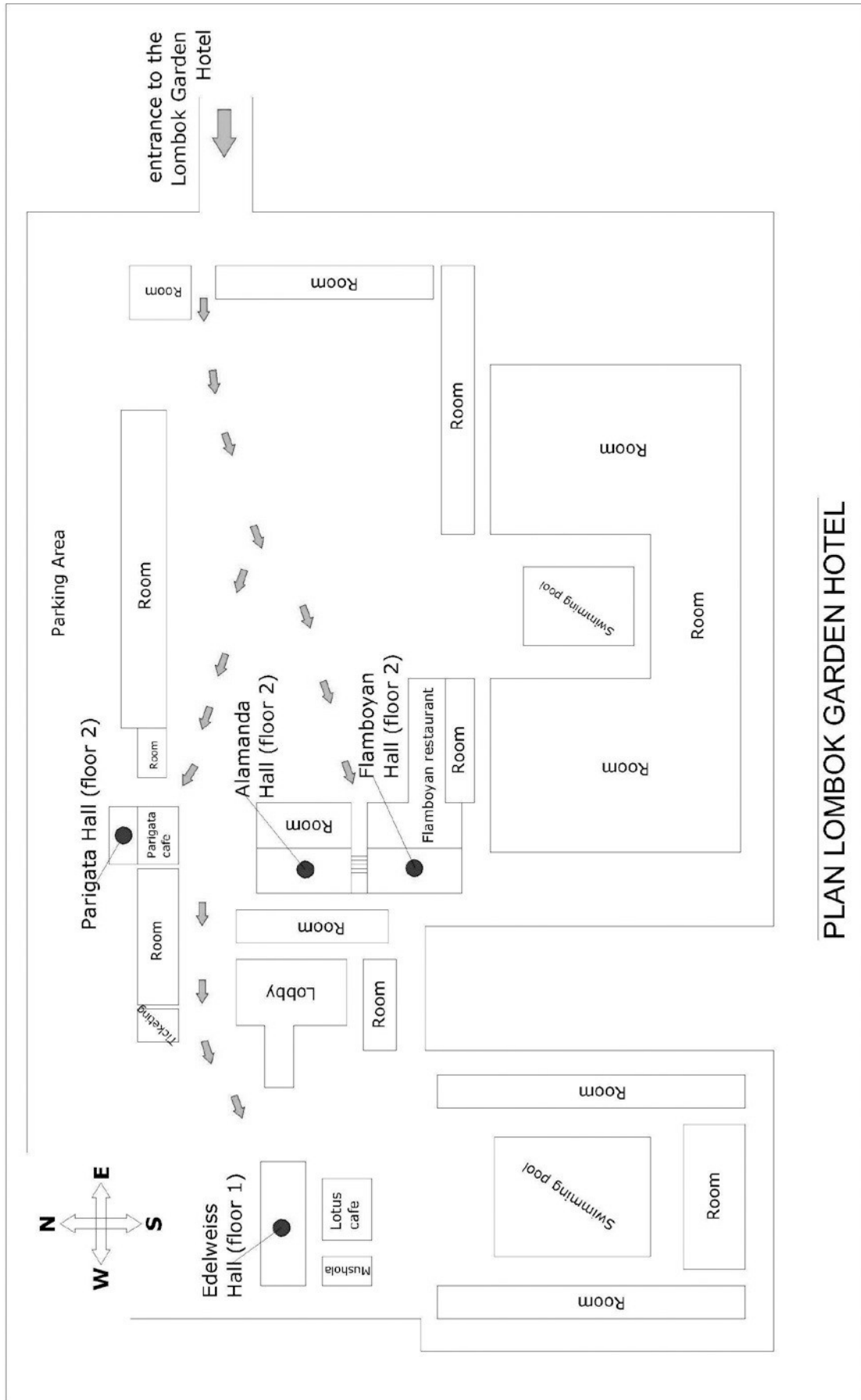

ACTIVITY LOCATOR AND FLOOR PLANS

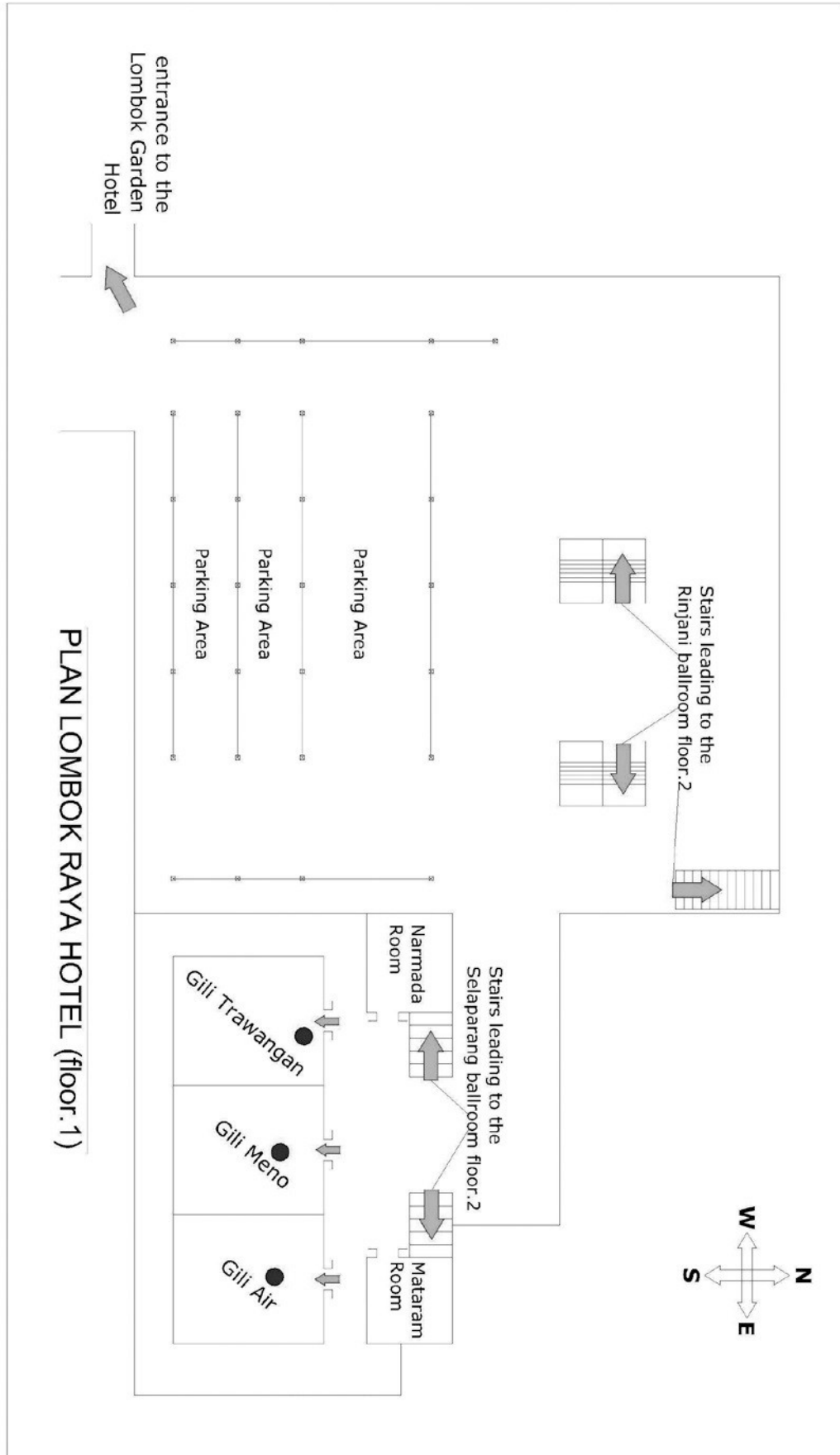

ACTIVITY LOCATOR AND FLOOR PLANS

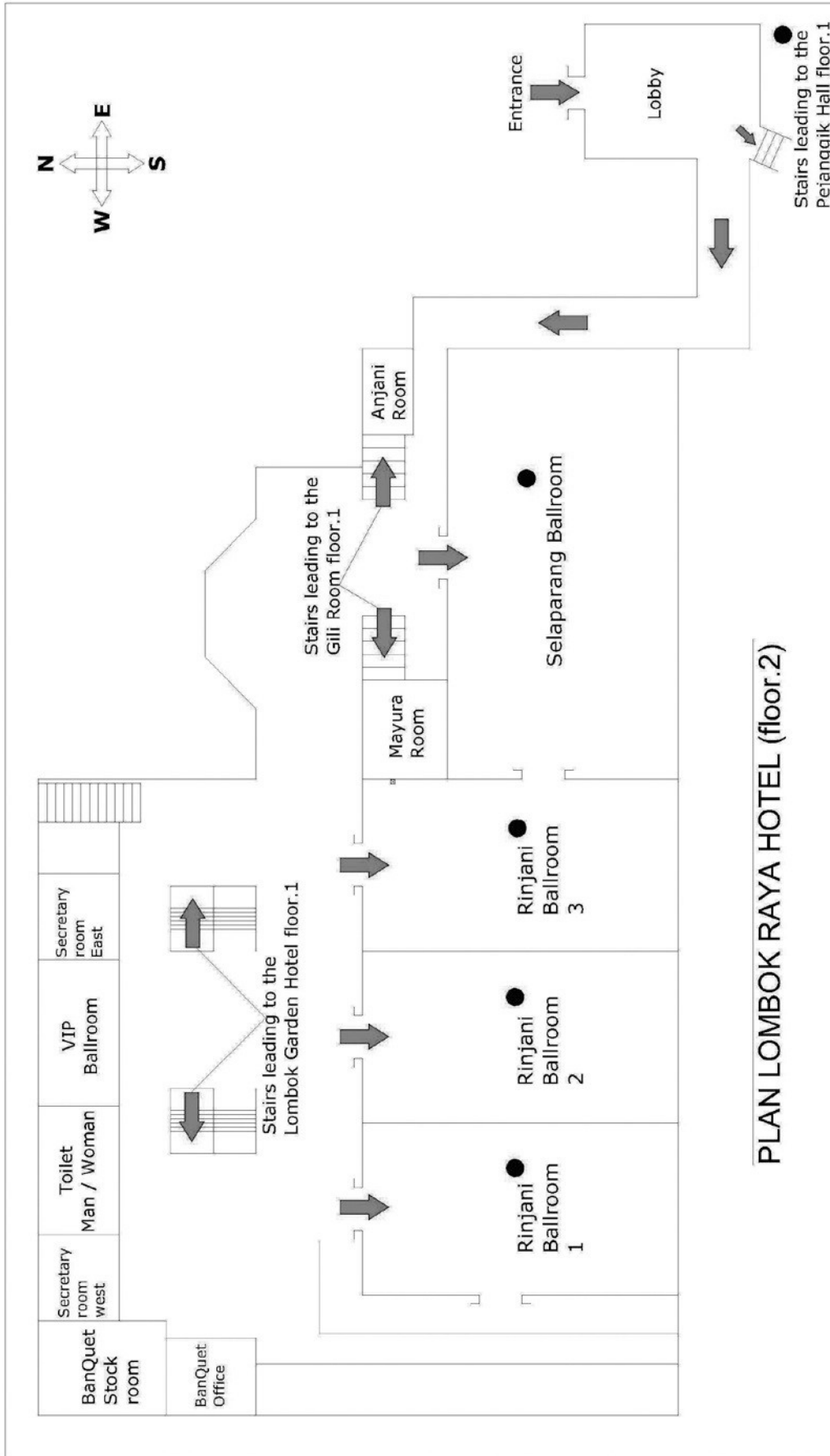

PROGRAM AT GLANCE

Date	Time	Program	Venue
10 August 2015	04.00- 06.00 pm	Registration and Welcome Drink	Pre-function Hall
11 August 2015	07.30- 08.00 am	Registration	Pre-function Hall
	08.00- 08.40 am	Opening Ceremony	Rinjani Room I, II, III
	08.40- 09.00 am	Photo Session	
	09.00- 09.30 am	Keynote Speech 1	
	09.30- 10.30 am	Talk show: Serve the Country	
	10.30- 10.45 am	Coffee break	
	10.45- 12.00 am	Keynote Speech 2 and 3	
	12.00- 01.00 pm	Lunch	Restaurant
		Poster Session Exhibition	Pre-function Hall
	01.00- 03.00 pm	Parallel session	Meeting Rooms
	03.00- 03.30 pm	Coffee Break	Pre-function Hall
		Poster Session Exhibition	
	03.30- 05.00 pm	Parallel session	Meeting Rooms
	05.00- 07.00 pm	Poster Session	Pre-function Hall
Exhibition			
07.00- 09.00 pm	Banquette Dinner	Rinjani Room I, II, III	
12 August 2015	08.00- 10.00 am	Parallel session	Meeting Rooms
	10.00- 10.30 am	Coffee Break	Pre-function Hall
		Poster Session	
		Exhibition	
	10.30- 12.00 am	Parallel session	Meeting Rooms
	12.00- 01.00 pm	Lunch	Restaurant
		Poster Session Exhibition	Pre-function Hall
	01.00- 03.00 pm	Parallel session	Meeting Rooms
	03.00- 03.30 pm	Coffee Break	Pre-function Hall
Poster Session Exhibition			
03.30- 05.00 pm	Parallel session	Meeting Rooms	
05.00 - 06.00 pm	Closing Ceremony	Selaparang Room	
13 August 2015	08.00 am- 08.00 pm	Social Tour Lombok	

Table of Contents

IN-SITU NONINVASIVE HEAT FLUX EVALUATION BY ULTRASOUND FOR HIGH TEMPERATURE MATERIAL PROCESS MONITORING.	1
ELASTIC-PLASTIC FRACTURE TOUGHNESS OF EXTRUDED Mg-Al-Zn ALLOYS.	3
FABRICATION AND EVALUATION OF MICRO-STRUCTURED REACTION FIELD WITH VERTICALLY ALIGNED CARBON NANOTUBES FOR MICRO BIO-ANALYSIS DEVICE	5
IMPROVEMENT OF MECHANICAL PROPERTIES IN UNTWISTED CNT YARN BY PAA/DMSO DENSIFICATION TREATMENT.	7
EFFECTS OF PROCESSING CONDITIONS IN UNIDIRECTIONAL CARBON FIBER THERMOPLASTIC PREPREG TAPE LAYING USING NEAR INFRARED HEATER	9
ESTIMATION OF ELECTRICAL CONDUCTIVITY OF TiB ₂ /Al COMPOSITES WITH IMAGE ANALYSIS.	11
NEW MANUFACTURING METHOD OF PARTICLE INTERMETALLIC COMPOUND REINFORCED COMPOSITES	13
THE EFFECT OF ZrO ₂ ADDITION ON THE ELECTROCHEMICAL BEHAVIOR OF LOW-CARBON STEELS IN CrO ₃ -H ₂ SO ₄ ELECTROLYTE	15
PRODUCTION AND IMPROVEMENT OF CHARACTERISTICS OF SINTERED POROUS TITANIUM USING CAPSULE-FREE HIP METHOD	17
PROPOSAL FOR NEW FABRICATION METHOD OF GREEN COMPOSITE BY USING FRICTION STIR PROCESS.	19
INFLUENCE OF GRAIN SIZE ON PROCESS AFFECTED ZONE IN MICRO PIERCING.	21
REPLICATION OF ANTIREFLECTION STRUCTURE FOR SOLAR CELLS BY LASER-ASSISTED IMPRINTING.	23
SELECTIVE PATTERN-HARDENING OF AISI-SUS420/SUS430 MOLDS FOR MICRO-TEXTURING.	25
EVALUATION OF MAGNETIZATION FOR CANTILEVER SAMPLE USING MEMS DEVICE	27
FABRICATION OF MICRO-CHANNEL FROM THE POWDER BY PULSE ELECTRIC CURRENT SINTERING METHOD AND MARKED GRAPHITE DIE.	29
NUMERICAL STUDY ON EFFECTS OF MATERIAL INHOMOGENEITY AND GRAIN SIZE ON NECKING AND WRINKLING BEHAVIORS IN MICRO DEEP DRAWING OF METAL FOILS	31
TECHNICAL MILESTONE TO APPLY SELF-HEALING CERAMICS	33

BLANKING VIBRATION AND NOISE OF DIFFERENT TENSILE STRENGTH MATERIALS IN SCREW DRIVE SERVO PRESS BLANKING	35
BEHAVIOR OF ASYMMETRIC DEFORMATION OF ROD IN LOCALLY-LATERAL UPSETTING	37
DIRECT MEASUREMENT OF FRICTION FORCE DURING FORMING	39
MEASUREMENT OF TOOL TEMPERATURE IN BURNISHING USING DIAMOND TIP	41
HIGH DENSITY OXYGEN PLASMA ASHING OF CVD-DIAMOND COATED END-MILLING TOOLS	43
FRONT AND REAR SIDES SIMULTANEOUS FORMING BY FRICTION STIR INCREMENTAL FORMING.	45
IN SITU OBSERVATIONS ON FRETTING WEAR BEHAVIOR OF PLASMA-SPRAYED HYDROXYAPATITE COATING	47
WETTABILITY BETWEEN GRAPHITE AND HIGH- TEMPERATURE LEAD-FREE SOLDER ALLOY	49
THE ROLE OF HYDROGEN IN HIGH RATE PLASMA NITRIDING OF MARTENSITE STAINLESS STEEL.	51
DEVELOPMENT OF TITANIUM FIBER/ALUMINUM MULTIFUNCTIONAL COMPOSITES.	53
PHASE-FILED SIMULATION OF ELEMENTARY PROCESS IN POWDER BED FUSION	55
ESTIMATION OF FRICTIONAL PERFORMANCE OF LUBRICANTS FOR HOT FORGING OF STEEL BY CARIBRATION CURVES CONSIDERING HEAT TRANSFER IN RING COMPRESSION TEST	57
DEVELOPMENT OF HIGH SPEED TORSIONAL FATIGUE TESTING MACHINE FOR MULTIPLE SPECIMENSDEVELOPMENT OF HIGH SPEED TORSIONAL FATIGUE TESTING MACHINE FOR MULTIPLE SPECIMENS	59
GUIDED WAVE PROPAGATION IN WIRE CABLE UNDER TENSILE STRESS.	61
BEHAVIOR ON GENERATION AND PROPAGATION OF FATIGUE CRACK FOR WC-Co CEMENTED CARBIDES	63
A DEVICE OF GAS TRANSMISSION RATE FOR THIN FILMS IN A HYDROGEN STORAGE SYSTEM.	65
THE STUDY OF VARIANT SELECTION FOR SHAPE MEMORY EFFECT ON FE-MN-SI BASED ALLOY WITH EBSD.	67
CHARACTERISTICS OF METAL MATRIX COMPOSITES REINFORCED WITH PALM OIL FLY ASH FABRICATED BY USING STIR CASTING AND CENTRIFUGAL CASTING METHODS	69

MECHANICAL PROPERTIES OF AMORPHOUS CARBON FILMS DEPOSITED FROM CARBON ISOTOPE MATERIALS	71
EVALUATION OF ADHESIVE STRENGTH BETWEEN Ti-29Nb-13Ta-4.6Zr ALLOY AND SOL-GEL FABRICATED HYDROXYAPATITE FILMS.	73
ADHESION BEHAVIOR OF MECHANICALLY JOINED PARTS OF ALUMINUM ALLOYS.	75
DEVELOPMENT FOR HYDROGEN STORAGE Mg-Ti SOLID SOLUTION BY MECHANICAL ALLOYING	77
DEVELOPMENT OF DAMAGE DETECTION TECHNIQUE FOR SHEET-TYPE LITHIUM-ION BATTERIES USING ACOUSTIC EMISSIONS.	79
IMPACT RESISTANCE OF THE GLASSES INSTALLED NANO-LAMIRATED FILMS AND ARAMID FIBER CLOTH	81
INFLUENCE OF ANNEALING ON SHAPE MEMORY PROPERTY IN FE-MN-SI BASED ALLOY	83
FRICITION STIR INCREMENTAL FORMING OF ALUMINUM ALLOY SHEETS WITH BACK SUPPORT DIE	85
DEVELOPMENT OF CU-SN ALLOY WITH MECHANICAL ALLOYING.	87
FEM SIMULATION FOR TWO-DIMENSION CUTTING OF TITANIUM-ALLOY	89
CORROSION RESISTANCE OF Si-DOPED AMORPHOUS CARBON FILMS AGAINST NITRIC ACID	91
TENSILE AND FATIGUE BEHAVIORS FOR LIP-SEAL WELDS OF LIQUID LITHIUM PIPES AT ELEVATED TEMPERATURE.	93
EFFECT OF LOCAL PLASTIC PROCESSING ON FATIGUE STRENGTH OF STEEL PLATE WITH A HOLE	95

A Multi-Objective Problems for Optimal Integration of the DG to the Grid using the NSGA-II

I Made Wartana

Electrical Department National Institute of Technology (ITN), Malang 65125, Indonesia
m.wartana@fti.itn.ac.id

Abstract— In recent years, integration of a wide variety of Distributed Generation (DG) technology in distribution networks has become one of the major management concerns for professional engineers. In this paper, one type of the DG i.e. Wind Turbine is optimally integrated in a power network for enhancing the performance of the network. A new variant of Genetic Algorithm (GA) dedicated in multi-objective optimization problems known as Non-dominated Sorting Genetic Algorithm II (NSGA-II) has been proposed for accomplishing the same. To aid the decision maker choosing the best compromise solutions from the Pareto front, the fuzzy-based mechanism is employed for this task. The NSGA-II is used to obtain the optimal integration and sizing of the DG in a suitable load bus of the system. Multi-objective functions are considered as the indices of the system performance viz: maximization of system loadability in system security and stability margin i.e. voltage and line limit whereas minimization of the real power loss of the transmission lines. Simulation studies are undertaken on modified IEEE 14-bus and a practical Indonesia Java-Bali 24-bus systems. Results show that the dynamic performance of the power system can be effectively improved by the optimal integration and sizing of the DG.

Keywords— DG; Multi-objective optimization; NSGA-II; security and stability margin; system loadability.

I. INTRODUCTION

The growing awareness of environmental issues and efforts to reduce dependency on fossil fuel resources are bringing renewable energy resources to the mainstream power sector. Among the various renewable resources, Distributed Generation-based wind power is assumed to have the most profitable technical and economic prospects [1]

The applications of DG in power system have received wide attention and scope in power system for several reasons. First, the DG helps to utilize the distributed but with small energy resources. Second, reducing the use of transmission capacity as most DG is located near the center of the load along with several types of DGs also provide reactive power to support the power system. Third, as the DG is located close to the load thus, it reduces transmission losses and at the same time improving system performance. The fourth advantage is to delay the investment in transmission lines and construction of large power plants. Above all, second option/advantage has been utilized in this chapter to enhance the system loadability by optimal placement of DGs in the network [2].

On the other hand, integration of a wide variety of DG technology in distribution networks has developed one of the

major management concerns for professional engineers. Some of the major technical benefits are improved voltage profile by reducing active power losses, enhanced system security and reliability for power quality improvement, increased overall energy efficiency [3] relieved transmission, and distribution congestion.

A lot of work was made on the optimal allocation of DG for different purposes. Different approach techniques have been suggested i.e., Genetic Algorithm (GA) [1], Quantum GA for optimal location and settings of multi-types of DG [2]. However, the system stability and security constraints are not entirely considered yet for maximizing the system loadability within any condition of the grid and their impact on the transmission loss with optimal integration of DG.

From these literature works, it can be observed that most of the problems for optimal location of DG was mostly expressed disparately as a mono-objective optimization problem [1],[2]. Unfortunately, the formulation of the problems as a mono-objective optimization is not quite practical. However, it is always good to take advantage of DG considering and minimize the interaction by formulating as a multi-objective problems and solve them simultaneously.

In this work, multi-objective problems have been formulated for maximizing the system loadability by optimal location and sizing of a DG, viz. Wind generation system or farm while maintaining the system security and stability margin within acceptable range. By means of DG optimal integration, the active power loss of the transmission systems was also minimized. The multi-objective problems have been solved simultaneously using the new variant of GA specialized in multi-objective optimizations problem, namely the NSGA-II.

II. MODELING OF DG

So far, there are several technologies from the DG of renewable technologies viz: solar, photovoltaic, wind, geothermal, ocean, etc. The DG units are modeled as synchronous generators for small hydro power, geothermal power, combined cycles and combustion turbines. They are treated as induction generators for wind and micro hydro power. DG units are considered as power electronic inverter generators such as micro gas turbines, solar power, photovoltaic power and fuel cells [4].

In this paper, the type 3 of the DG namely doubly fed induction generators (DFIG) has been employed which are applied for the energy conversion, called as variable speed

systems, the power electronic interface which is used to connect DGs with utility, also provides some reactive power support. References [5] provide a detailed description of the operation of a DFIGN.

III. PROBLEM FORMULATION

As indicated, the goal of the stated optimization problem is the optimal integration of DG into power network in order to maximize the loadability, with security and stability margins, and minimize the real power loss in transmission lines. The optimal integration and sizing of DG is formulated as a real constrained mixed discrete continuous multi-objective optimization problem that has two objective functions to be optimized simultaneously:

$$\text{Minimize } F(\mathbf{x}, \mathbf{u}) = [F_1(\mathbf{x}, \mathbf{u}), F_2(\mathbf{x}, \mathbf{u})] \quad (1)$$

$$\text{Subject to } \begin{cases} g(\mathbf{x}, \mathbf{u}) = 0 & j = 1, \dots, M \\ h(\mathbf{x}, \mathbf{u}) \leq 0 & k = 1, \dots, K \end{cases} \quad (2)$$

where F is known as the objective vector, F_1 and F_2 are the bi-objective functions to be optimized, \mathbf{x} is the vector of dependent variables, and \mathbf{u} is the vector of control variables.

In all optimization problems several cases in terms of use of the DG are considered namely: (a) Case-1: base case, (b) Case-2: with DG. The objective functions considered in this paper are presented in detail as given below.

A. Maximize the system loadability within security margin

$$\text{Maximize } F_1(\mathbf{x}, \mathbf{u}) = \{\lambda_1\} \quad (3)$$

$$\text{Subject to } VL = \sum_{i=1}^{N_L} OLL_i + \sum_{j=1}^{N_E} BVV_j \quad (4)$$

where VL is the thermal and bus violation limit factor, OLL_i and BVV_j represent the overloaded line factor and branch the bus voltage violation factor respectively and will be expatiated on later; N_L and N_E are the total numbers of transmission lines and load buses respectively; and λ_1 is a load parameter of the system, which aims to find the maximum amount of power that the network is able to supply within system security margin. The load parameter λ_1 in (3) is defined as a function of a load factor λ_f [6]:

$$\lambda_1 = \exp[\gamma |\lambda_f - \lambda_f^{\max}|] \quad \lambda_f \in [1, \lambda_f^{\max}] \quad (5)$$

where γ is the coefficient to adjust the slope of the function, and λ_f^{\max} is the maximal limit of λ_f . The load factor λ_f reflects the variation of power demands P_{Di} and Q_{Di} , which are defined as:

$$P_{Di}(\lambda_f) = \lambda_f P_{Di} \quad (6)$$

$$Q_{Di}(\lambda_f) = \lambda_f Q_{Di} \quad (7)$$

where $i = 1, \dots, N_D$ and N_D is the total number of power demand buses. $\lambda_f = 1$ indicates the base load case.

The index of system security state contains two parts [4]. The first part, OLL_i , relates to the branch loading and penalizes overloads in the lines. The value of OLL_i equals to λ_1 if the j th branch loading is less than its rating. OLL_i increases logarithmly (actual logarithm) with the overload.

The second part BVV_j in (4) concerns the voltage levels for each bus of the power network. Similar to OLL_i , The value of BVV_j equals to λ_1 if the voltage level falls between the voltage minimal and maximal limits. Outside the range, BVV_j increases exponentially with the voltage deviation.

B. Minimization of Real Power Loss of the transmission lines

This objective is to minimize the real power loss (P_{loss}) in the transmission lines and which can be expressed as [7]:

$$\text{Minimize } P_{loss} = \sum_{k=1}^{nl} g_k [V_i^2 + V_j^2 - 2V_i V_j \cos(\delta_i - \delta_j)] \quad (8)$$

Where, nl is the number of transmission lines; g_k is the conductance of the k^{th} line; $V_i \angle \delta_i$ and $V_j \angle \delta_j$ are the voltages at the end buses i and j of the k^{th} line, respectively.

C. Equality Constraints

These constraints represent the typical load flow equations as follows:

$$P_{G_i} = P_{D_i} + V_i \sum_{j=1}^{N_i} V_j (G_{ij} \cos \theta_{ij} - B_{ij} \sin \theta_{ij}) \quad i = 1, \dots, N_G \quad (9)$$

$$Q_{G_i} = Q_{D_i} + V_i \sum_{j=1}^{N_i} V_j (G_{ij} \sin \theta_{ij} - B_{ij} \cos \theta_{ij}) \quad i = 1, \dots, N_{PQ} \quad (10)$$

Where N_i is the number of buses adjacent to bus i including bus i , N_{PQ} and N_G are the number of PQ buses and total buses excluding slack bus, respectively.

D. Inequality Constraints

The inequality constraints $h(\mathbf{x}, \mathbf{u})$ are limits of control variables and state variables. Generator active power P_G , reactive power Q_G and voltage V_G are restricted by their limits as follows:

$$\begin{aligned} P_{G_i}^{\min} &\leq P_{G_i} \leq P_{G_i}^{\max} & i = 1, \dots, N_G \\ Q_{G_i}^{\min} &\leq Q_{G_i} \leq Q_{G_i}^{\max} & i = 1, \dots, N_G \\ V_{G_i}^{\min} &\leq V_{G_i} \leq V_{G_i}^{\max} & i = 1, \dots, N_G \end{aligned} \quad (11)$$

The constraints of load voltages at load buses V_L and transmission loading P_L are represented as:

$$\begin{aligned} V_{L_i}^{\min} &\leq V_{L_i} \leq V_{L_i}^{\max} & i = 1, \dots, N_L \\ |P_{L_i}| &\leq P_{L_i}^{\max} & i = 1, \dots, N_E \end{aligned} \quad (12)$$

E. Power System Stability dan Security Margins

• Fast Voltage Stability Index

Fast Voltage Stability Index (FVSI) proposed by Musirin [8] is utilized in this paper to assure the safe bus loading. The line that exhibits FVSI close to 1.00 implies that it is approaching its instability point. If FVSI goes beyond 1.00, one of the buses connected to the line will experience a sudden voltage drop leading to the collapse of the system. FVSI index incorporation in the controller assures that no bus will collapse due to overloading.

• Line Stability Factor

System stability index is also assured by Line Stability Factor (LQP) proposed by A Mohamed et al [9]. The LQP

should be less than 1.00 to maintain a stable system. LQP assure the controller that no line is over loaded under any grid condition.

IV. NON DOMINATED SORTING GENETIC ALGORITHM (NSGA-II)

A. NSGA-II Optimization Principle

The capabilities of multi-objective genetic algorithms (MOGAs) to explore and discover Pareto optimal fronts on multi-objective optimization problems have been well recognized. It has been shown that MOGAs outperform traditional deterministic methods to this type of problem due to their capacity to explore and combine various solutions to find the Pareto front in a single run. We will implement a multi-objective optimization technique called the Non-Dominated Sorting Genetic Algorithm II (NSGA-II), which is described in detail by Deb et al. [10]

B. Best Compromise Solution

Once the Pareto optimal set is obtained, it is practical to choose one solution from all solutions that satisfy different goals to some extends. Due to the imprecise nature of the decision maker's (DM) judgment, it is natural to assume that the DM may have fuzzy or imprecise nature goals of each objective function [7]. Hence, the membership functions are introduced to represents the goals of each objective function; each membership function is defined by the experiences and intuitive knowledge of the decision maker. In this study, a simple linear membership function was considered for each of the objective functions.

V. SIMULATION

The NSGA II algorithm is carried out in the modified IEEE 14-bus test system [5]. The type DG incorporated in this simulation is Variable Speed Wind Turbine with DFIG which injects both active and reactive power. The loads are typically represented as constant PQ loads with constant power factor, and increased according to (6) and (7). The DG should be formed at low voltage side, consisting of buses.

TABLE I. NSGA-II PARAMETERS

Population	Generation	Pool Size	Tour Size	η_c	η_m
100	100	25	2	20	20

The number of DG is specified by user, here as equal one and only DG type 3 is considered. The parameters of NSGA-II for all optimization cases are summarized in Table I.

A. IEEE 14-bus system

This test system [5], consists of two generators, located at buses-1 and 2; three synchronous compensators used only for reactive power support at buses-3, 6, and 8. The best locations, sizings of the DG, maximum system loadability (SL) and minimum active power loss (Ploss) have been obtained using the NSGA-II technique for each case as given in Tables II, and III. The Pareto fronts for the best compromise solutions of all cases for the bi-objective optimizations are also presented in Figs. 1 and 2, respectively.

• Case-1: basecase (without DG)

For base case, the SL and P_{loss} have been obtained as given in Table II using the NSGA-II technique which the Pareto fronts for the best compromise solution (CS) of the case for the bi-objective problem is presented in Fig. 1.

TABLE II. OPTIMAL SL FOR BI-OBJECTIVES OPTIMIZATION OF IEEE14-BUS SYSTEM

	Location	Sizing		$SL(F_1)$	$P_{loss}(F_2)$
	(bus)	MW	MVAR	(%)	(pu)
Best SL	-	-	-	149.59	0.3593
Best P_{loss}	-	-	-	111.51	0.1625
Best CS	-	-	-	114.40	0.1704

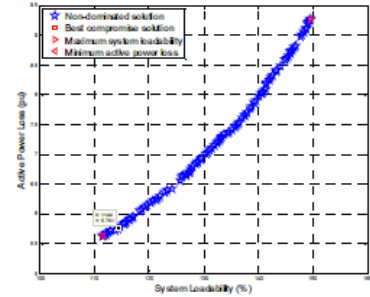

Fig. 1. Pareto front of base case for bi-objective optimization of IEEE 14-bus system.

• Case-2: with DG

The obtained results for Case-2 presented in Table III indicate that the best CS of optimal integration of the DG within the network by considering all stability constraints is found at bus 8 with size of 49.91 MW and -11.56 MVAR.

TABLE III. OPTIMAL INTEGRATION OF DG FOR BI-OBJECTIVES OPTIMIZATION OF IEEE14-BUS SYSTEM

	Location	Sizing		$SL(F_1)$	$P_{loss}(F_2)$
	(bus)	MW	MVAR	(%)	(pu)
Best SL	8	87.52	-3.24	157.08	0.4885
Best P_{loss}	14	47.47	-17.34	112.24	0.1772
Best CS	8	49.91	-11.46	128.27	0.2239

Whereas in Fig. 2 shows the Pareto front of the optimization problem of this case, in the objective space of SL and P_{loss} . This set of solutions on the non-dominated frontier is used by the decision maker as the input to select a final CS by using the normalized membership function.

Moreover, the installation of the DG at the same bus provides the best SL of 157.08 % as well but with the P_{loss} of 0.4885 pu which is the highest in this case. In addition, this SL is quite large compare with the result obtained in base case as given in Table II. The best P_{loss} in this case have been obtained of 0.1772 pu by installing the DG at bus 14 but it can increase the SL only 112.24% which is the lowest SL the this case.

The voltage and line stability indices represented by FVSI and LPQ for case-2 is quite less than 1.00 as depicted in Fig. 3. These indices are used to maintain grid stability at various levels of SL which ensure that no bus will collapse due to overloading and no line is over loaded under any grid condition.

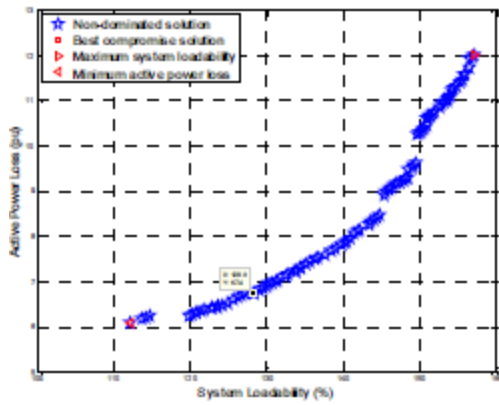

Fig. 2. Pareto front to find optimal integrations and sizing of DG for biobjective optimization of IEEE 14-bus system.

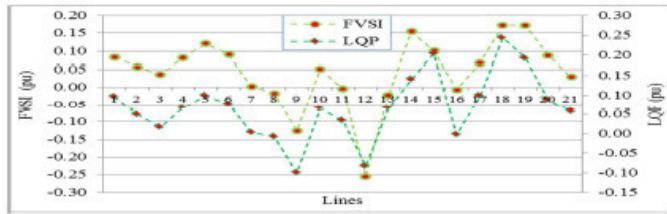

Fig. 3. FVSI and LQP of optimal integrations and sizing of DG for IEEE 14-bus system.

When compare with [1], the proposed results need more 31.37 MW size of DG to increase SL of 12.24 % but P_{loss} is higher 12.84 % than the result in [1] as shown in Table IV. With the same location at bus 14, the result obtained in [3] is required less of 7.77 MW size of DG compare with the proposed method to find P_{loss} of 28.83 MW. The P_{loss} is higher 62.7 % compared with the proposed method. Moreover, the SL by considering all stability constraints of the standard IEEE 14-bus test system are not incorporated in [1] and [3]. Therefore, the suggested approach in this paper has been found as more suitable and practical compared with reported literature for similar work.

TABLE IV. OPTIMAL INETRATION, SL, SIZE, P_{Loss} AND MINIMUM NUMBER OF DG (N) NEEDED IN IEEE 14-BUS SYSTEM

Obtained Results of DG integration	N	SL (%)	Total Size (MW)	P_{loss} (MW)	Optimal Locations (bus)	Considered stability (section F)
Proposed method	1	112.24	47.47	17.72	14	Yes
[1]	1	100	16	11.70	8	No
[3]	2	100	40	28.83	14	No

B. Indonesia Java-Bali 24-bus system

In order to give a more real feature to this study, the proposed method has been applied on the practical Indonesia Java-Bali 24-bus grid system which has 8 generators and 49 lines [11] as shown in Fig. 4. The total active and reactive load of the system are 10570.87 MW and 4549.23 MVAR respectively. Table V summarizes that the extreme points and the optimal integration of the DG for bi-objective optimization of this system using the suggested technique.

The results obtained in Table V indicates that the best CS with optimal integration of DG to the grid is found at bus-13 (CLGON) as the best locations of the DG, with sizing of 57.04 MW and -19.54 MVAR. The Pareto fronts for the best CS of is obtained as shown in Fig. 5. The stability of the system represented by their FVSI and LQP are also less than 1.00.

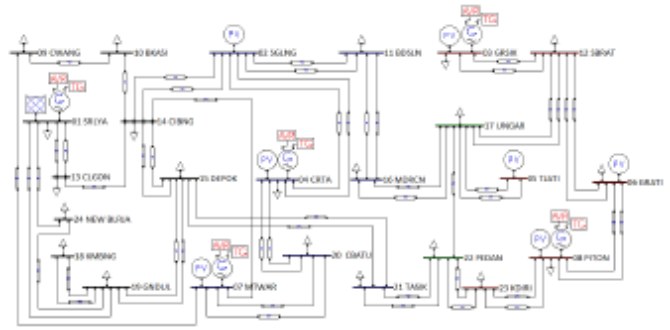

Fig. 4. Single line diagram of Indonesia Java-Bali 24-bus system

TABLE V. OPTIMAL INTEGRATION OF DG FOR BI-OBJECTIVES OPTIMIZATION OF INDONESIA JAVA-BALI 24-BUS SYSTEM

	Location	Sizing		$SL(F_1)$	$P_{loss}(F_2)$
	(bus)	MW	MVAR	(%)	(pu)
Best SL	14	142.54	-51.17	159.45	4.0471
Best P_{loss}	13	57.04	-19.54	129.00	1.1917
Best CS	13	57.04	-19.54	129.00	1.1917

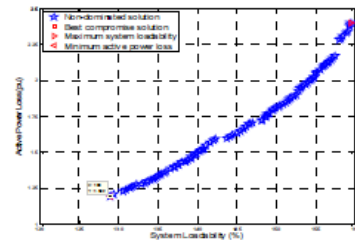

Fig. 5. Pareto front to find optimal integration of DG for bi-objective optimization of Indonesia Java Bali 24-bus system.

VI. CONCLUSIONS

A novel approach based on NSGA-II has been presented in this work and applied to optimal integration, and sizing of one type of DG in power network. The problem is formulated as a real mixed continuous integer multi-objective optimization problem. Two different problems are considered viz, maximize system loadability (SL) and minimize real power losses (P_{loss}) have been simultaneously solved as a bi-objective optimization problem. In each case, the optimal integration, and sizing of the DG are performed for several uses of the devices by considering security and stability constraints. To maintain the Pareto front size, a crowding distance technique is used; moreover, a fuzzy based mechanism is engaged to extract the best compromise solution from the Pareto front. The results show that the NSGA-II provides well distributed non dominated solutions and well exploration of the research space.

Acknowledgment

The author express their gratitude to the Directorate General of Higher Education, Ministry of Education and Culture of The Republic of Indonesia for providing grant to conduct this research.

References

- [1] S. Ghosh, S. P. Ghoshal, and S. Ghosh, "Optimal sizing and placement of distributed generation in a network system," *International Journal of Electrical Power & Energy Systems*, vol. 32, pp. 849-856, 2010.
- [2] A. Anwar and H. R. Pota, "Loss reduction of power distribution network using optimum size and location of distributed generation," in *Universities Power Engineering Conference (AUPEC), 2011 21st Australasian*, 2011, pp. 1-6.
- [3] C. Xi and G. Wenzhong, "Effects of Distributed Generation on power loss, loadability and stability," in *Southeastcon, 2008. IEEE, 2008*, pp. 468-473.
- [4] K. Buayai, I. M. Wartana, S. Sreedharan, and W. Ongsakul, "A Multiobjective Optimal Placement of Multi-Type DG for Enhancement of Power System Performance by NSGA-II," *GREATER MEKONG SUBREGION ACADEMIC AND RESEARCH NETWORK*, p. 97, 2011.
- [5] F. Milano, "An Open Source Power System Analysis Toolbox," *Power Systems, IEEE Transactions on*, vol. 20, pp. 1199-1206, 2005.
- [6] Z. Lu and M. S. Li, Jiang, L., Wu, Q. H., "Optimal allocation of FACTS devices with multiple objectives achieved by bacterial swarming algorithm," in *Power and Energy Society General Meeting-Conversion and Delivery of Electrical Energy in the 21st Century, 2008 IEEE, 2008*, pp. 1-7.
- [7] R. Benabid and M. Boudour, Abido, M. A., "Optimal location and setting of SVC and TCSC devices using non-dominated sorting particle swarm optimization," *Electric Power Systems Research*, vol. 79, pp. 1668-1677, 2009.
- [8] I. Musirin and T. K. Abdul Rahman, "Novel fast voltage stability index (FVSI) for voltage stability analysis in power transmission system," in *Student Conference on Research and Development, SCOREd 2002, 2002*, pp. 265-268.
- [9] M. V. Suganyadevia and C. K. Babulal, "Estimating of loadability margin of a power system by comparing Voltage Stability Indices," in *2009 International Conference on Control, Automation, Communication and Energy Conservation, INCACEC 2009. , 2009*, pp. 1-4.
- [10] K. Deb, A. Pratap, S. Agarwal, and T. Meyarivan, "A fast and elitist multiobjective genetic algorithm: NSGA-II," *Evolutionary Computation, IEEE Transactions on*, vol. 6, pp. 182-197, 2002.
- [11] P3B, "The 2010 Operation Plan," *The Indonesian Government Electrical Company, PT PLN (PERSERO), Cinere 61514, Jakarta Selatan, Indonesia 2010*.



UNIVERSITAS
INDONESIA
Veritas, Probitas, Justitia | Est. 1849

QiR The 14th International Conference on QiR (Quality in Research)

Lombok
Indonesia

Certificate

This is to certify that

I Made Wartana

attended

The 14th International Conference on QiR (Quality in
Research)

10-13 August 2015, Lombok, Indonesia

as

Author

Universitas Indonesia
Faculty of Engineering
Dean,



Prof. Dr. Ir. Dedi Priadi, DEA.

QiR 2015
General Chair,

Dr. Fitri Yuli Zulkifli, ST., M.Sc.